

814-1

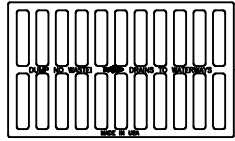

STANDARD GRATE

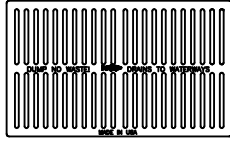

ADA PEDESTRIAN SAFETY

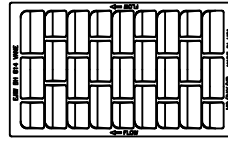

STANDARD VANE

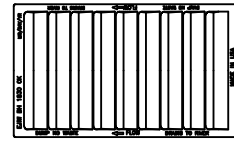

1830 OK VANE

GRATE OPTIONS AVAILABLE

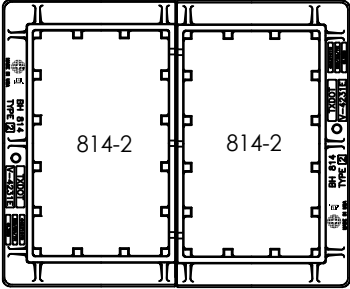

814-2

814-2

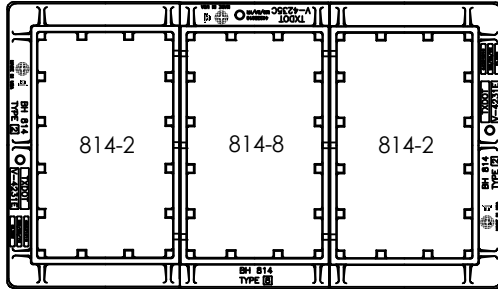

814-2

814-8

814-2

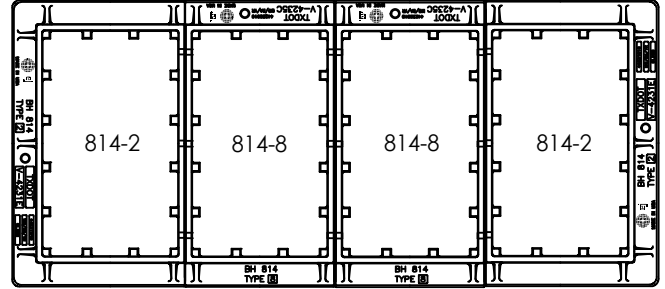

814-2

814-8

814-8

814-2

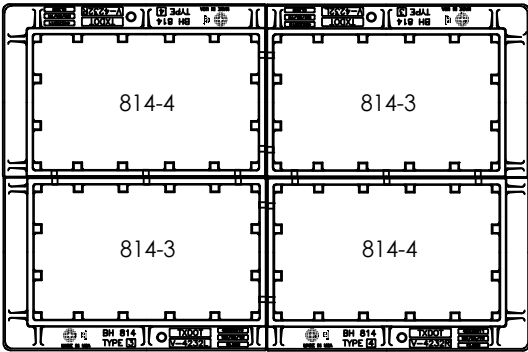

814-4

814-3

814-3

814-4

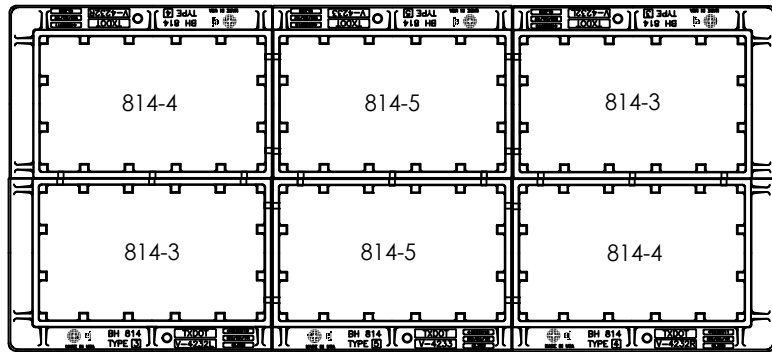

814-4

814-5

814-3

814-3

814-5

814-4

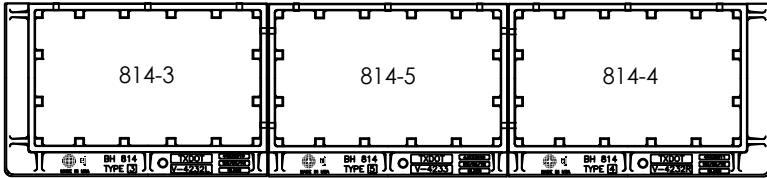

814-3

814-5

814-4

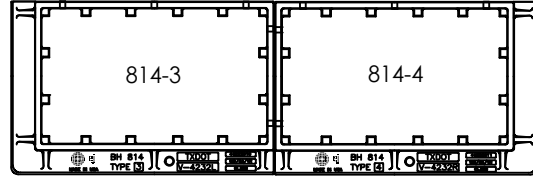

814-3

814-4

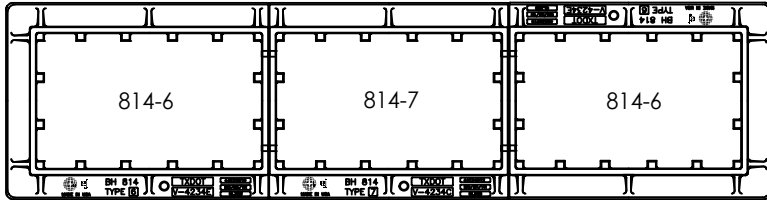

814-6

814-7

814-6

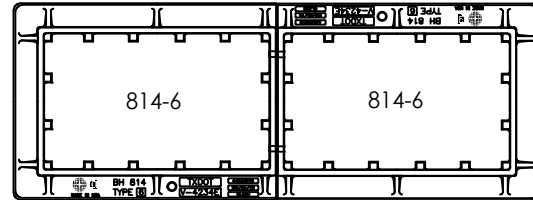

814-6

814-6

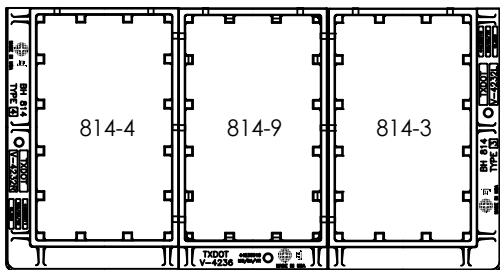

814-4

814-9

814-3

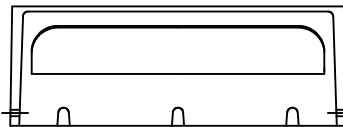
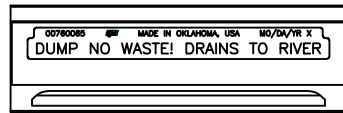

BOLT-ON CURB HOODS

Frames are H-20 traffic rated when properly installed in reinforced concrete and used with an H-20 rated grate. Must use I-Beams and Bolts/Nuts as necessary.

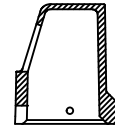

SECTION

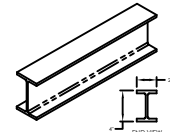

We stock 4X7 support I-beams



Grand Prairie, Texas

TOLL FREE: 1-800-258-2278

DFW METRO: 972-263-1360

LOCAL: 972-262-1012 FAX: 972-263-0091

sales@basshays.com www.basshays.com

PATTERN NUMBER:

BH® 814® SERIES

DESCRIPTION: Cast Iron 18" X 30" Frame & Grate
TXDOT Standard Specs
ASTM A48 Gray Iron CL35B
Made In USA

FRAME WEIGHT- 190 LBS.

GRATE WEIGHT- 153 LBS.

SET WEIGHT- 343 LBS.

DRAWN BY:
JJJ 11-01 / SDC 5-12

REVISED BY:
MH 1-16